



JEEP S.A.S EUROPE 1945

FRANCE

JEEP S.A.S FRANCE

1945

PAR DARK VADOR

**(SUR BASE DE TONI
MAURICIO)**

**ECH DE
BASE:
1/17**

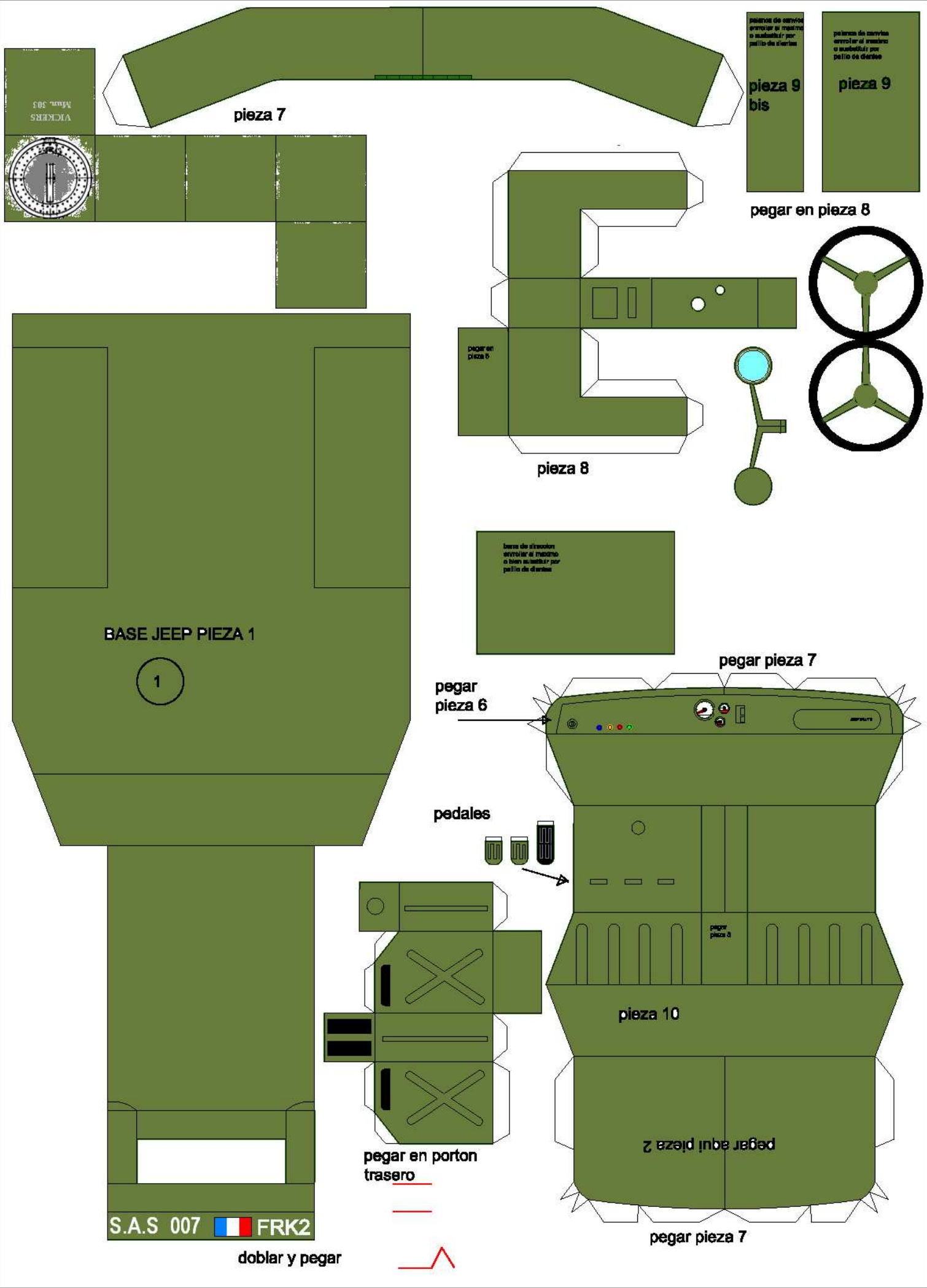

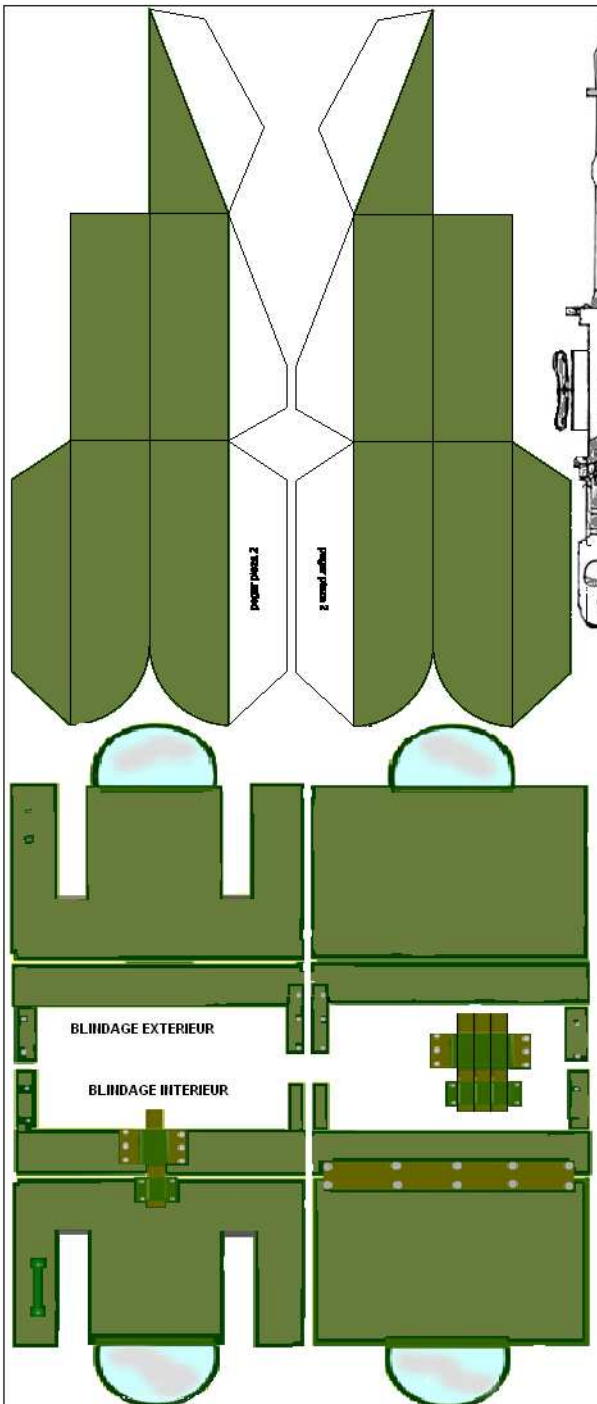
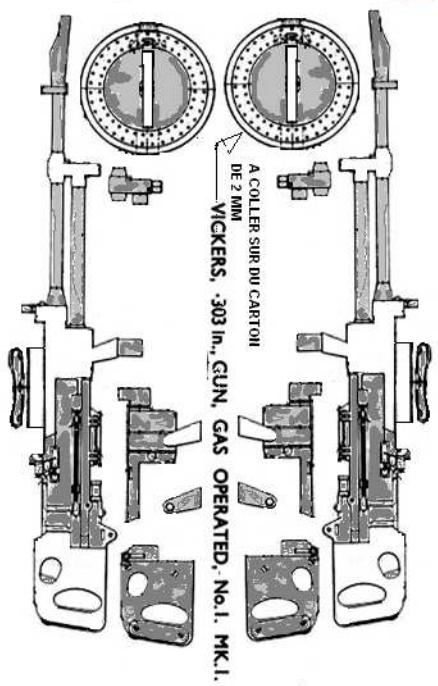
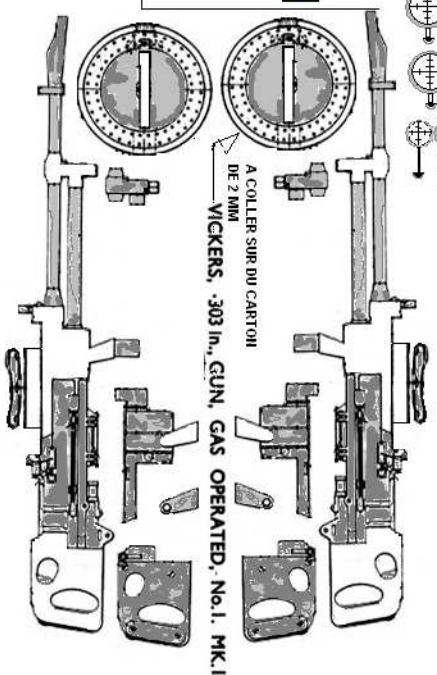
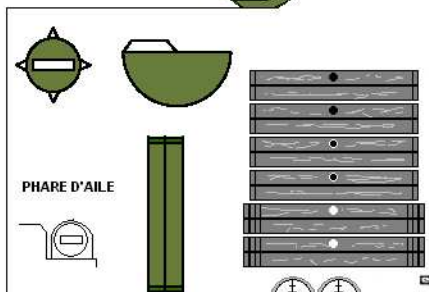
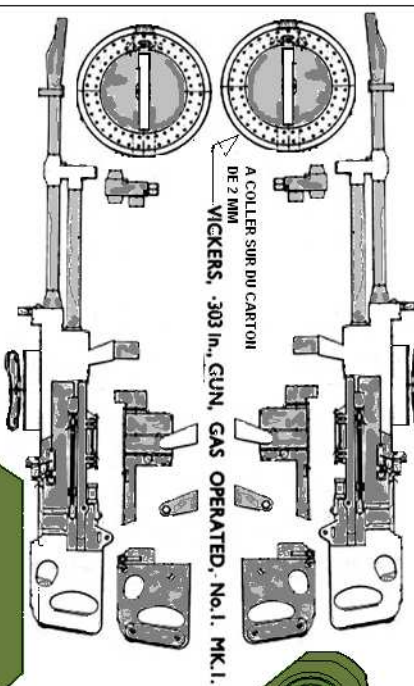
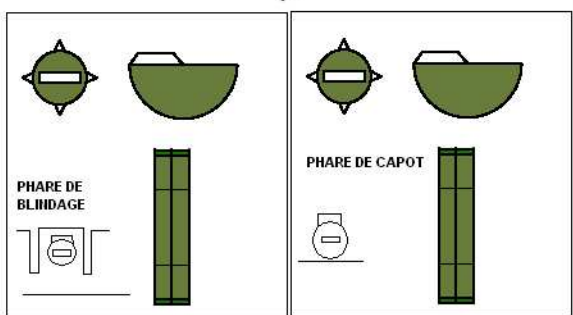
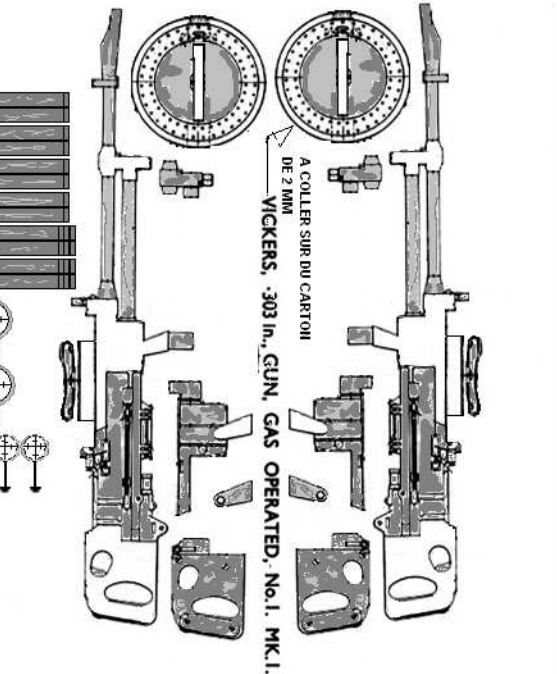
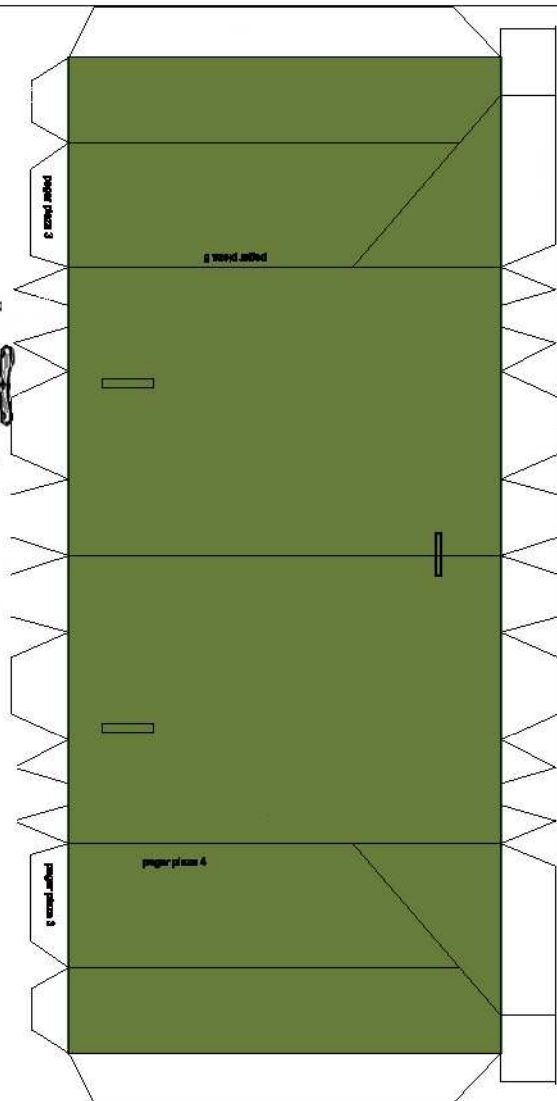

piezas 14 y 15,
pegar por dentro de
hueco de ruedas
traseras

pieza 13
guardabarros interno
izquierdo

pegar pieza 10

cortar ✂

pegar aquí al centro

pieza
11

pegar
en base
1

pegar aquí pieza 8

pegar aquí al centro

cortar ✂

pegar pieza 12

pieza 12
guardabarros interno
derecho

S.A.S 007

FRK2

piezas 16 y 17
paragolpe trasero

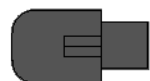

pala, pegar en palillo de
dientes y colocar en lateral
según foto

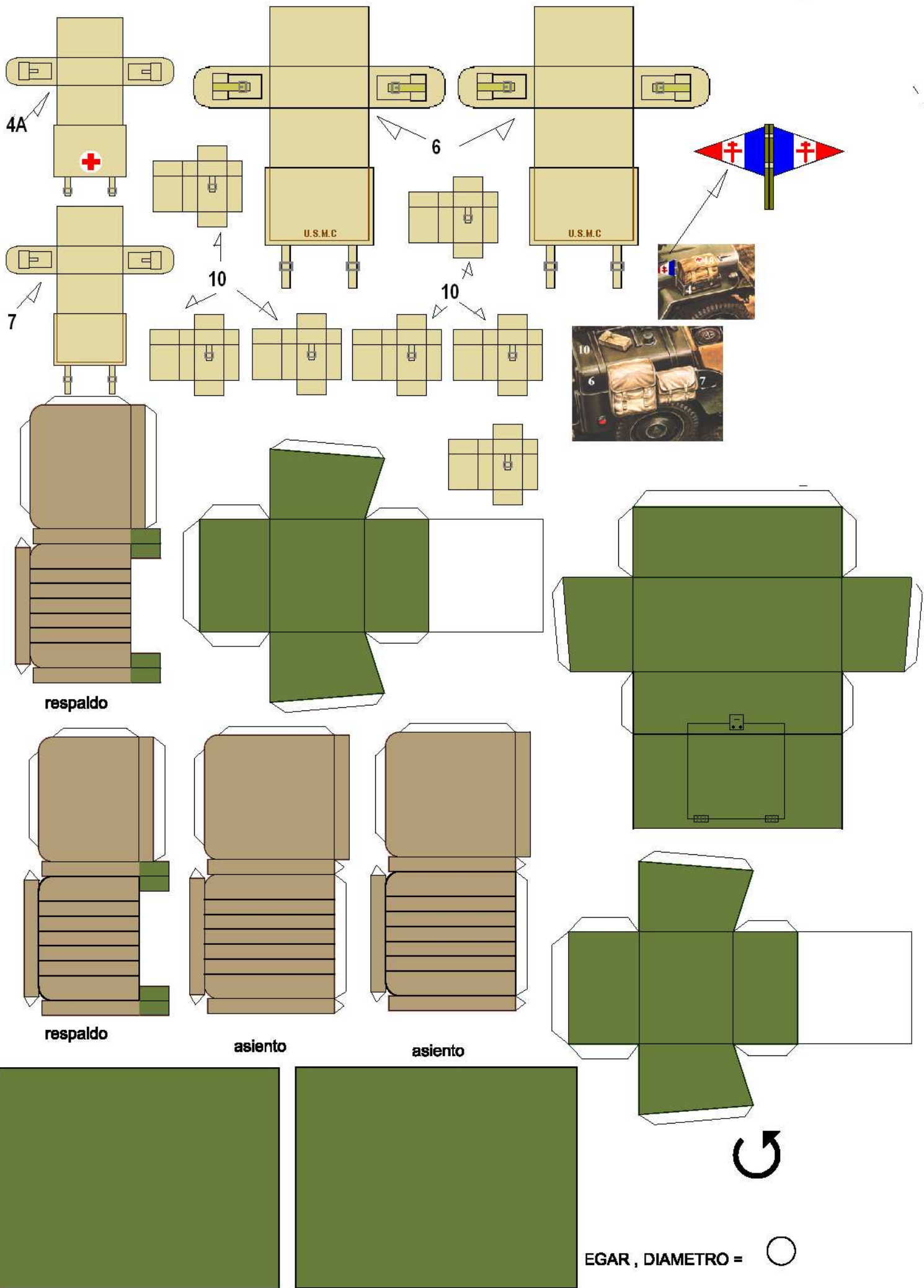

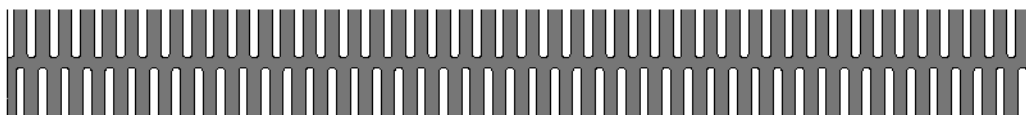
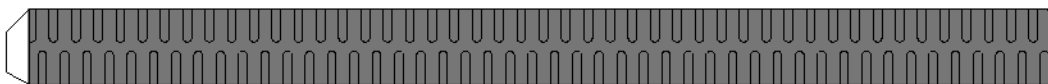
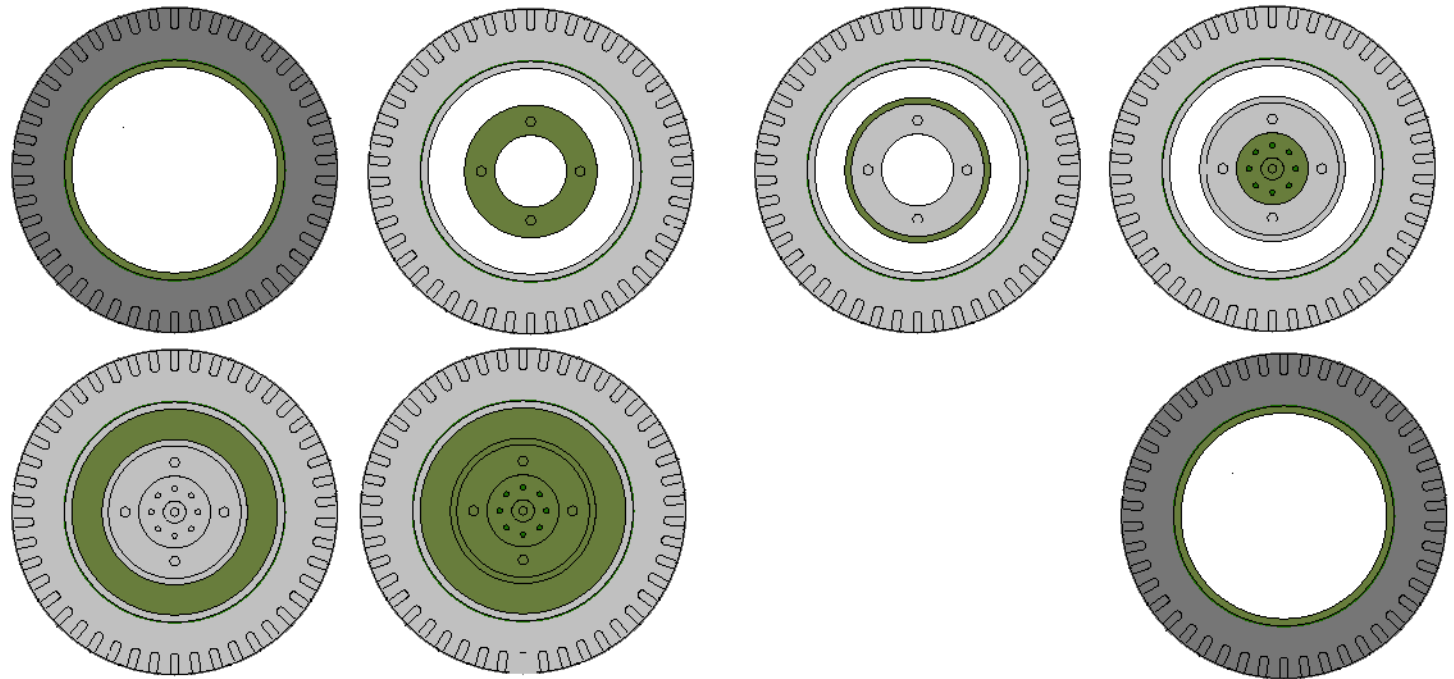
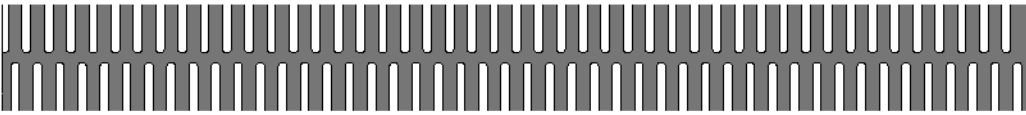
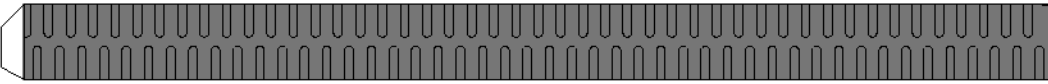
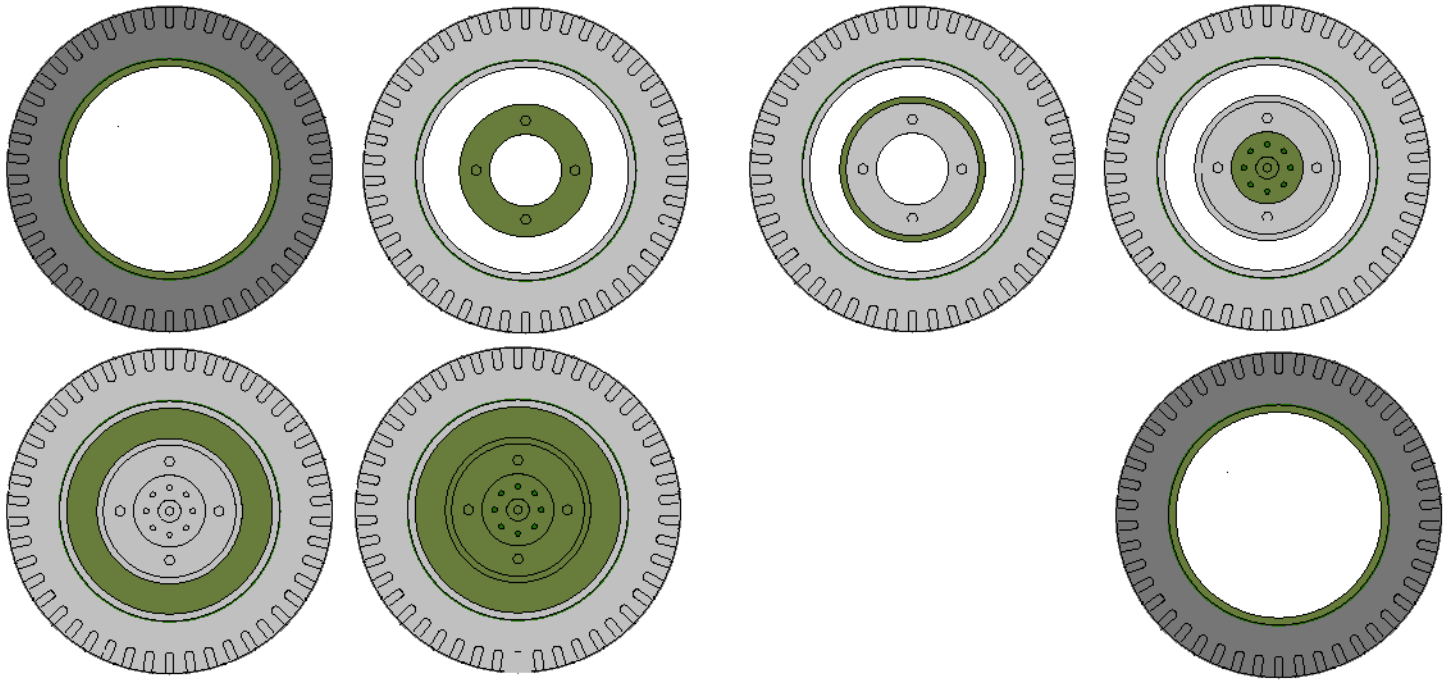

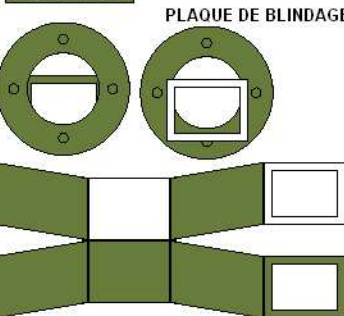
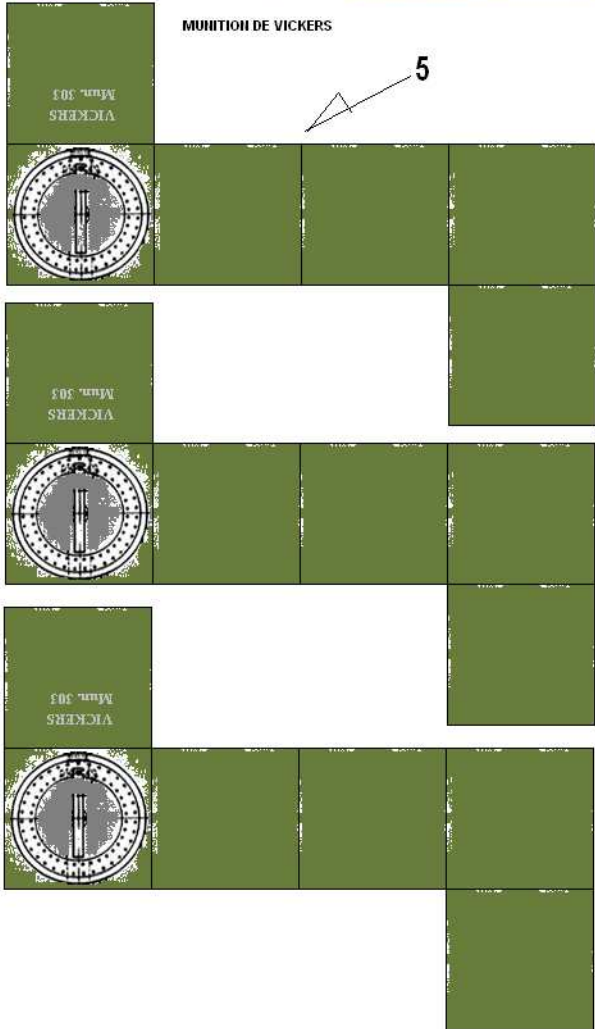

PORTE ROUE

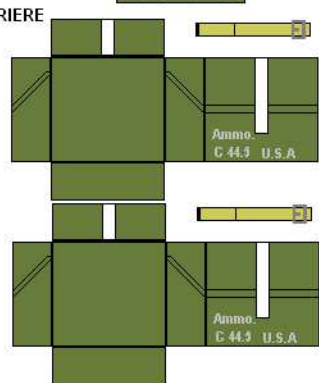

RESERVOIR ADDITIONNELS

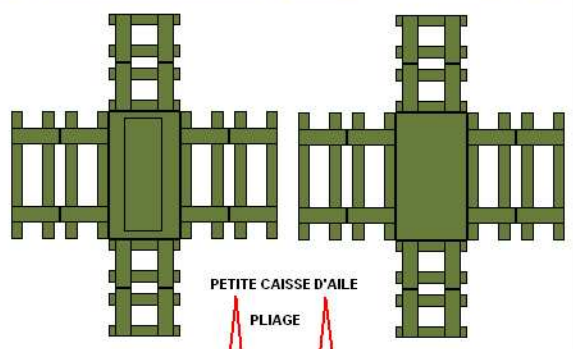
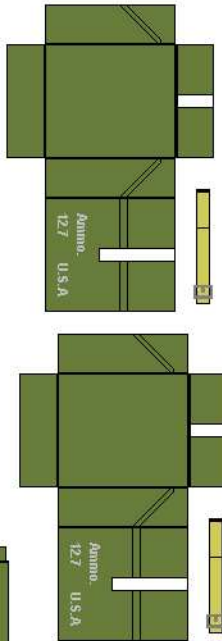
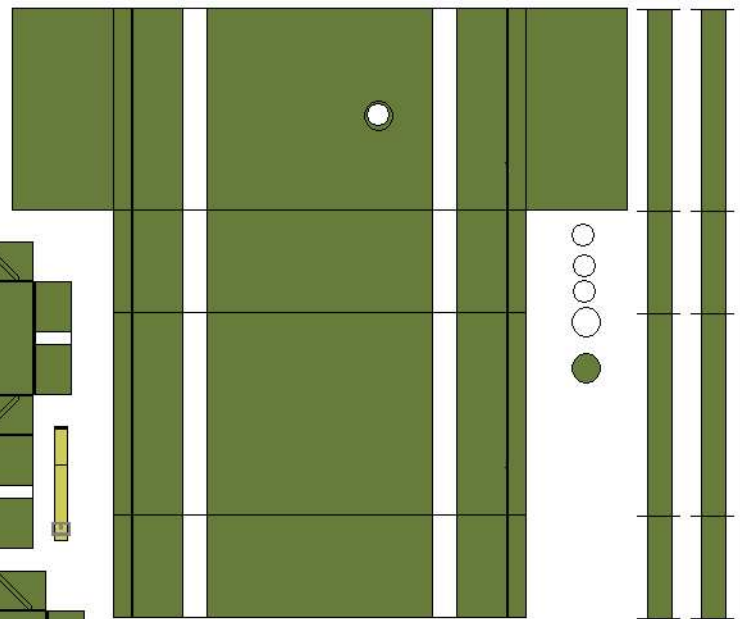
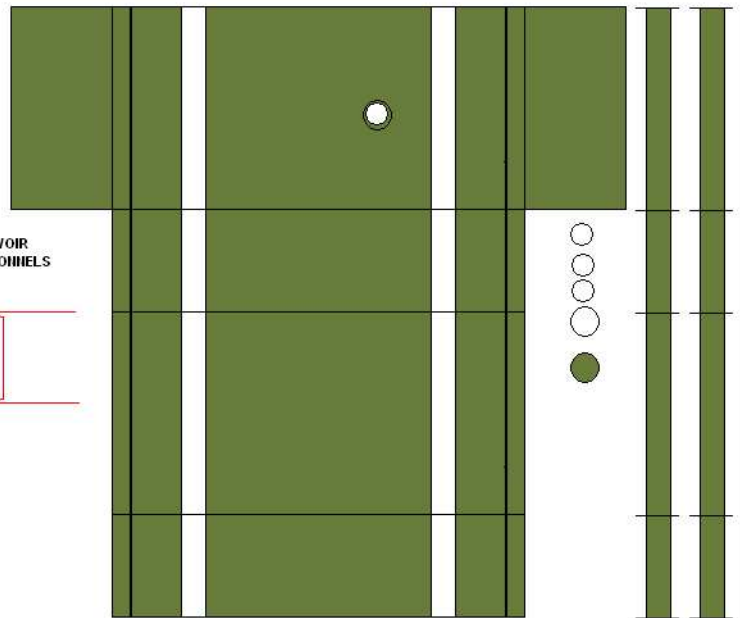

PETITE CAISSE D'AILE



POSITION DE LA ROUE ET DE LA PLAQUE DE BLINDAGE

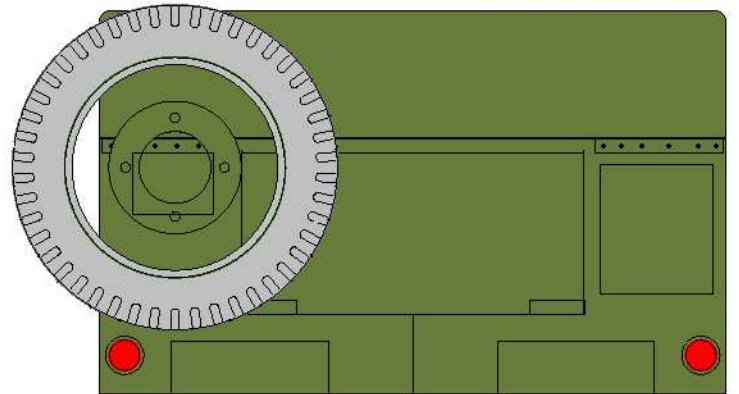

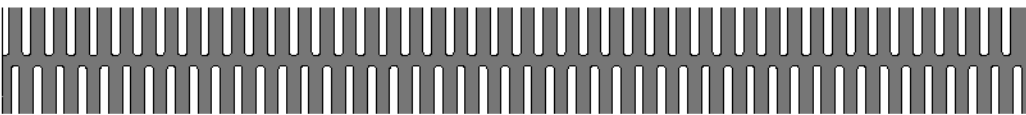
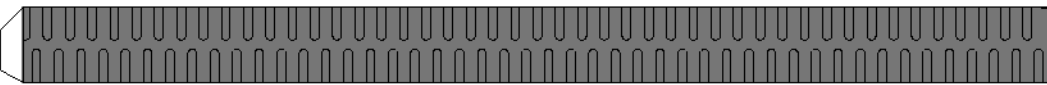
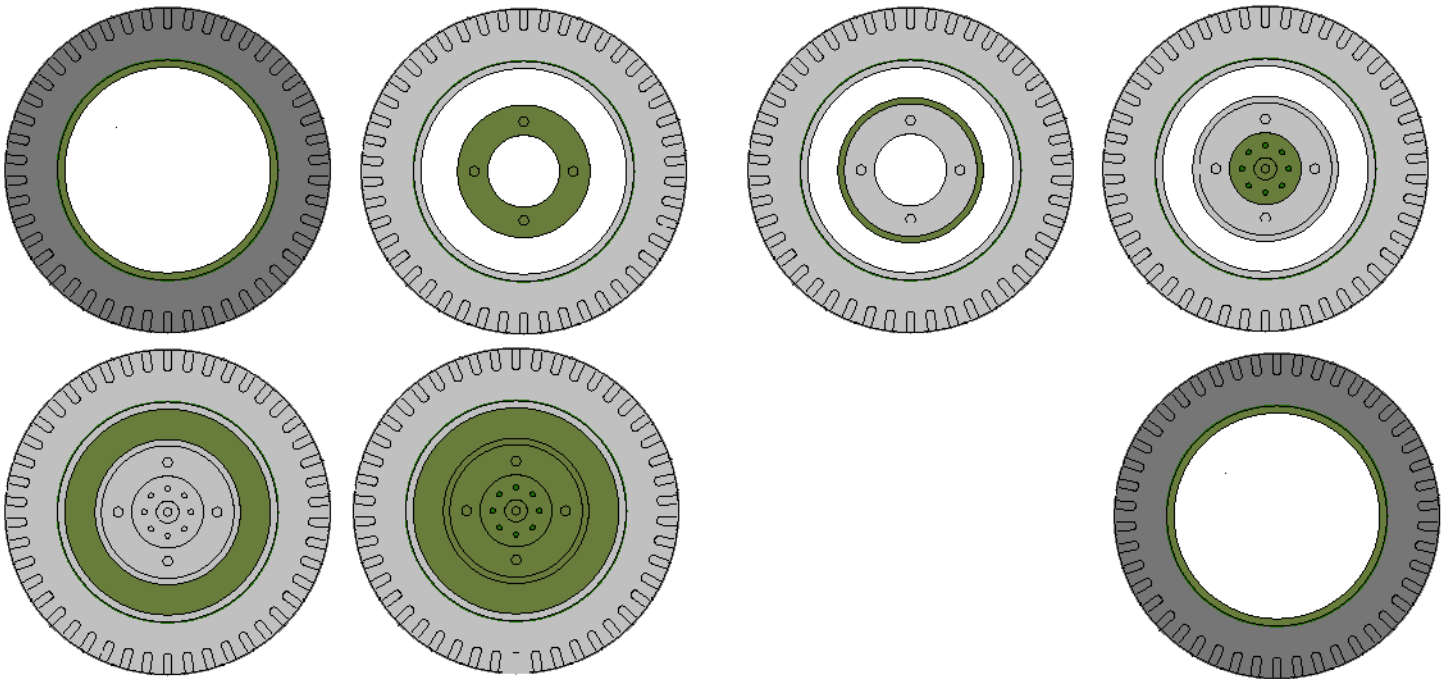
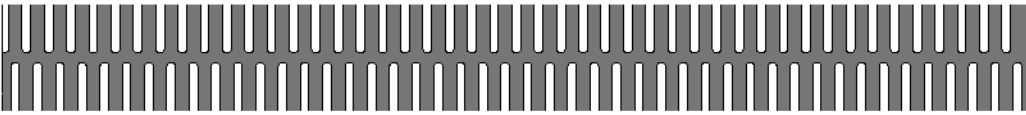
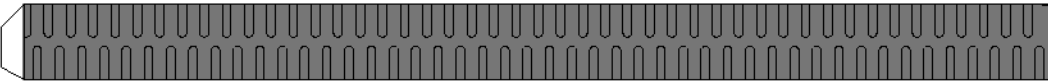
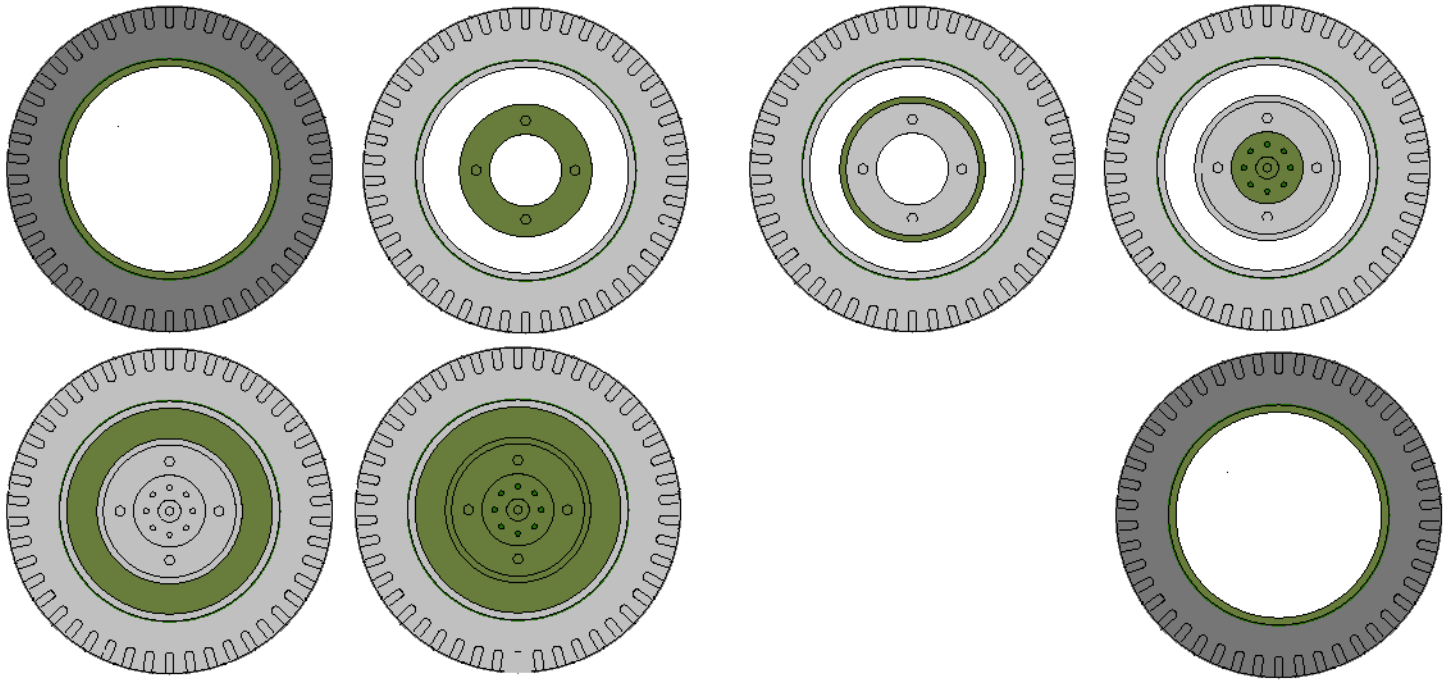

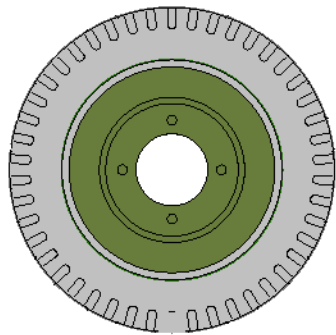
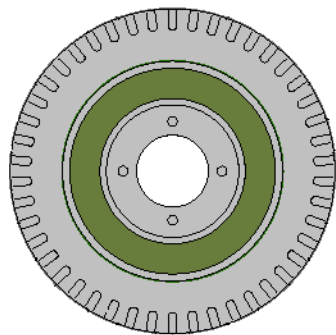
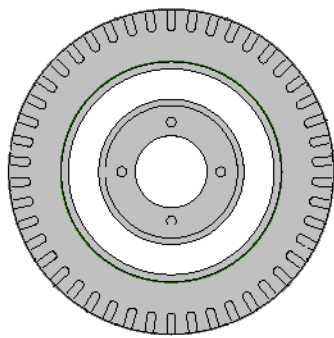
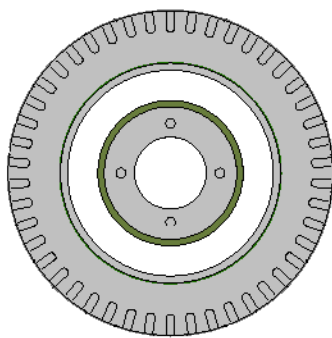
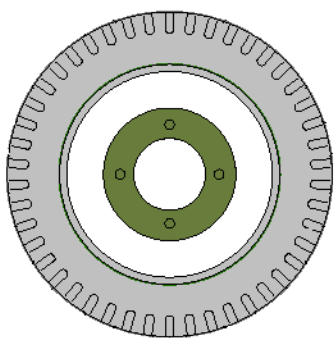
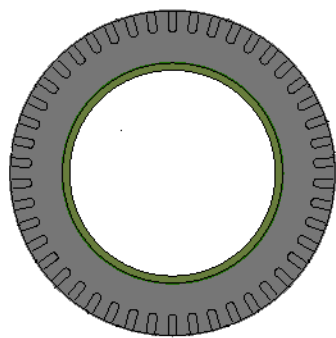

ROUE DE SECOURS

