

SU 76 M

Char Russe de 1943
2° guerre mondiale

Production 11 300 unités de mai 1943 à 1945
Motorisation 2 x GAZ-203 de 170 Ch.
Vitesse maximale 45 Km/h
Équipage 4 hommes
Masse 11,2 tonnes
Longueur 4,9 m
Hauteur 2,2 m
Largeur 2,7 m
Armement Canon ZiS-3 mod. 1942 de 76,2 mm

1 Numero de la piece

1* Carton de 0.5 mm

1** Carton de 1 mm

1 Papier 160 gr

W Zone à evider

ou A couper

Pièce à rouler

Pièce à plier

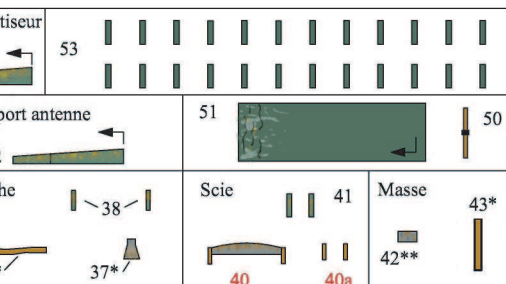
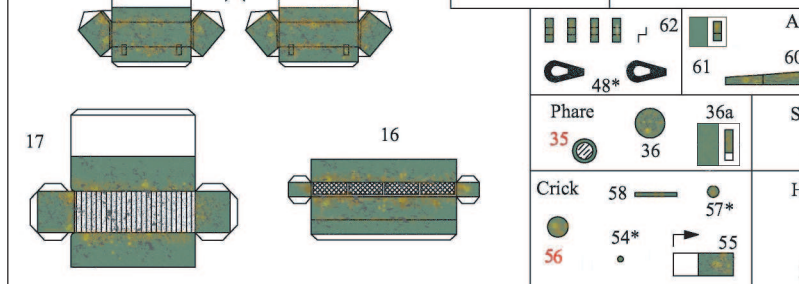
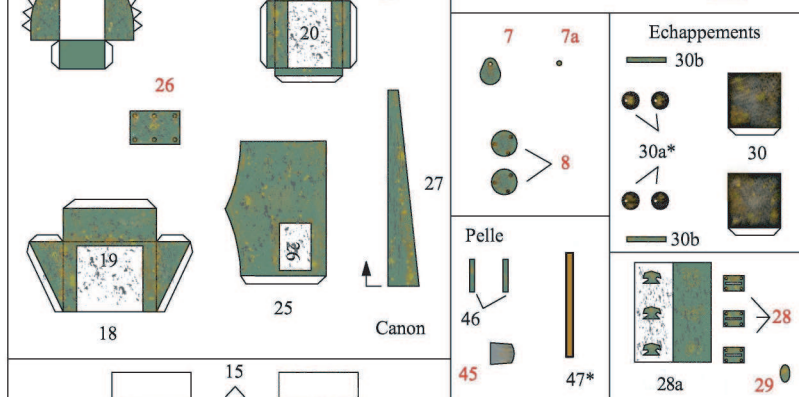
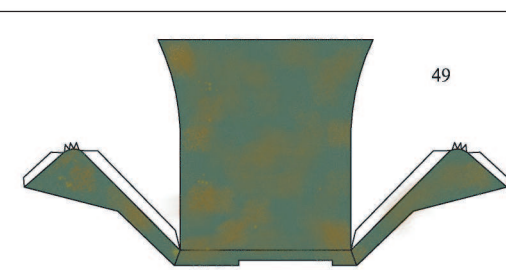
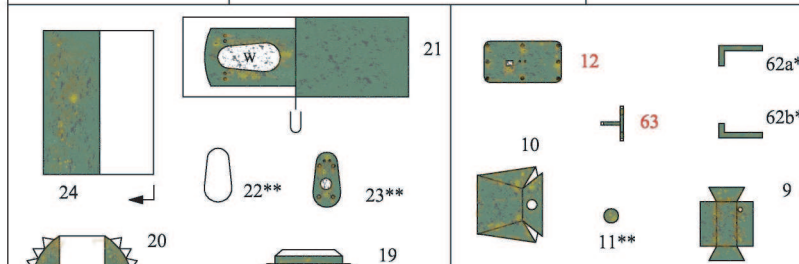
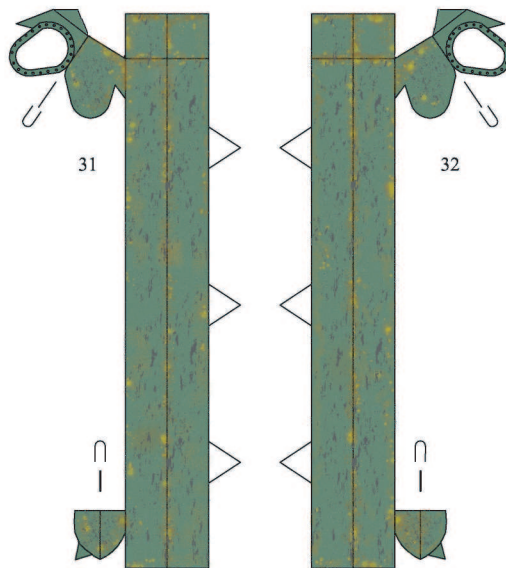
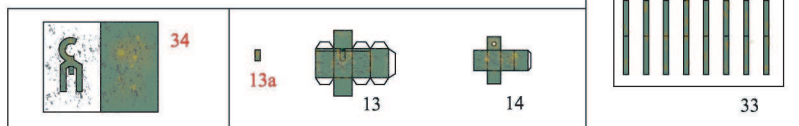
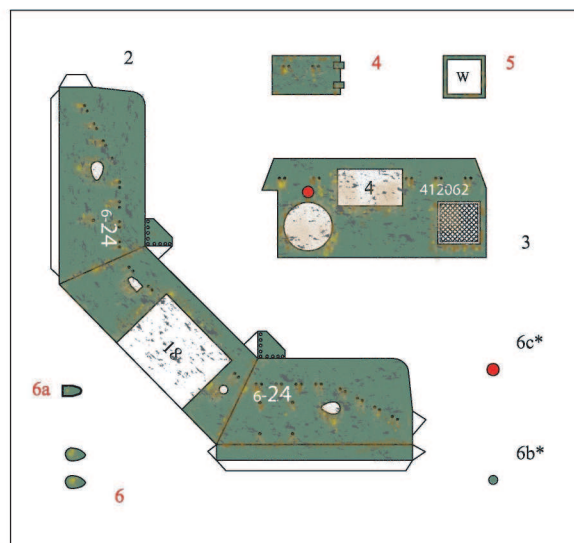
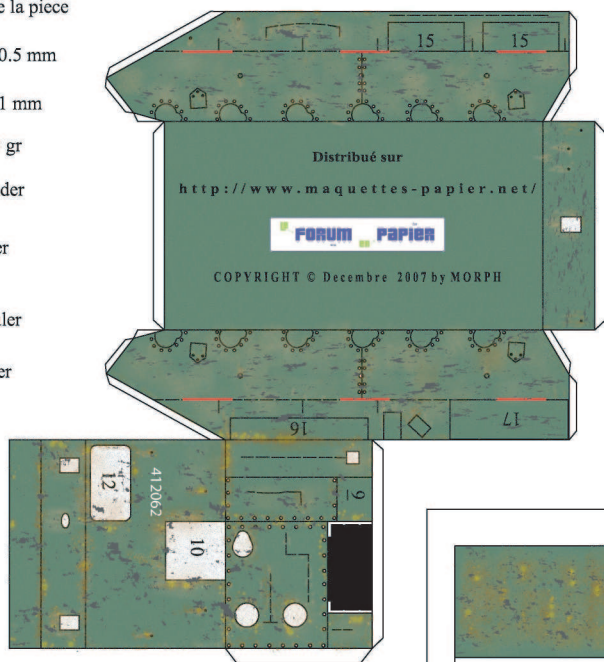

A IMPRIMER SUR PAPIER 90/100 gr

