

# NAVY YARD PLANCHE 1

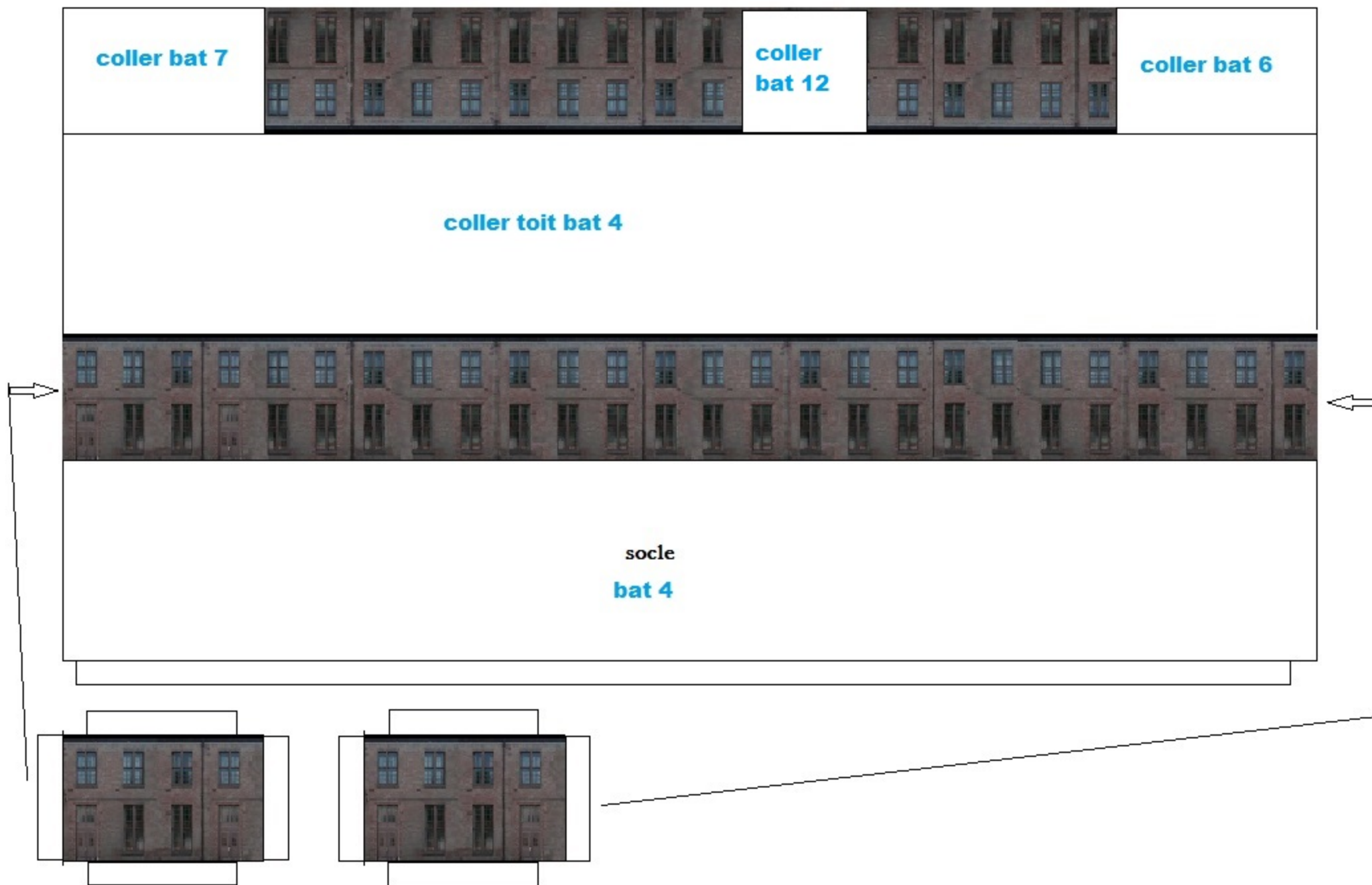

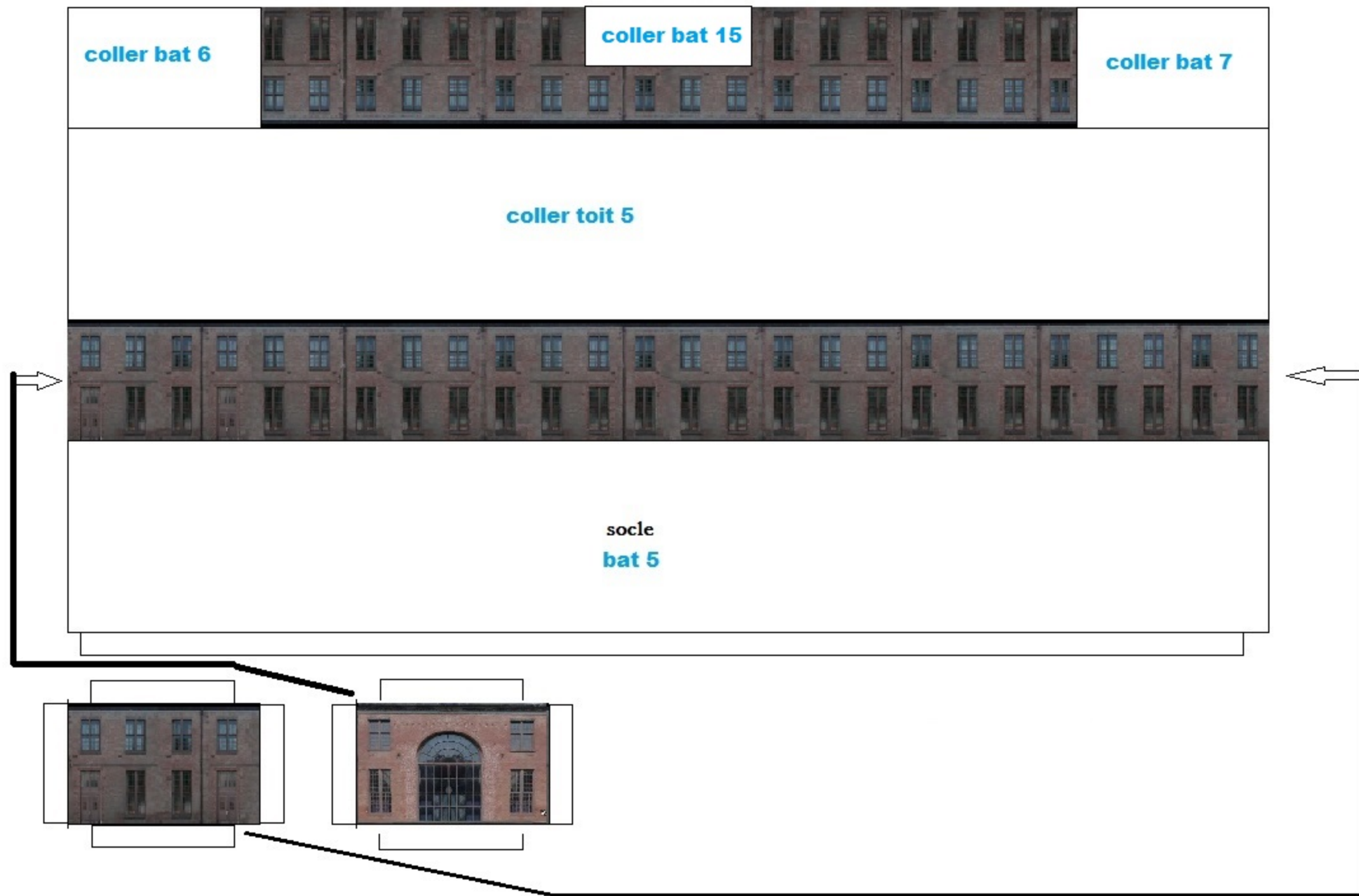

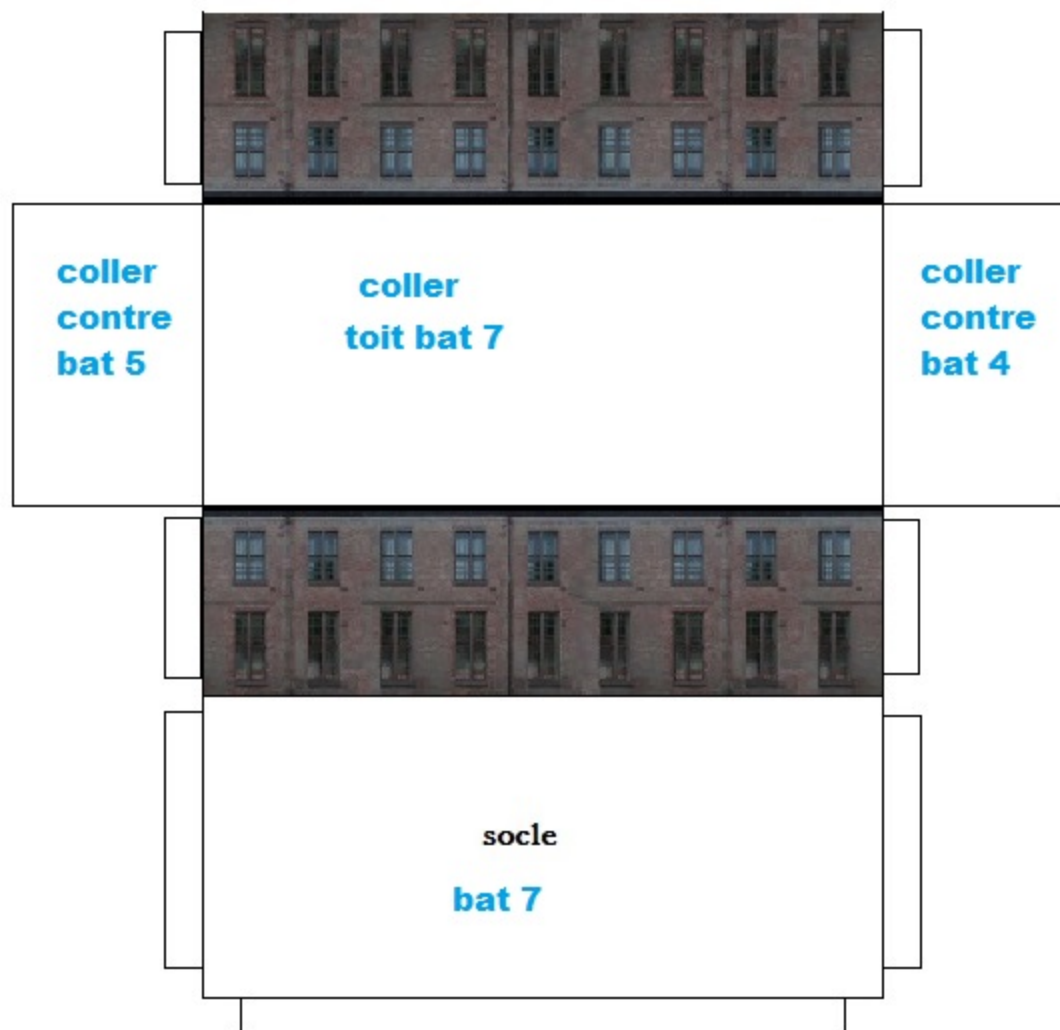

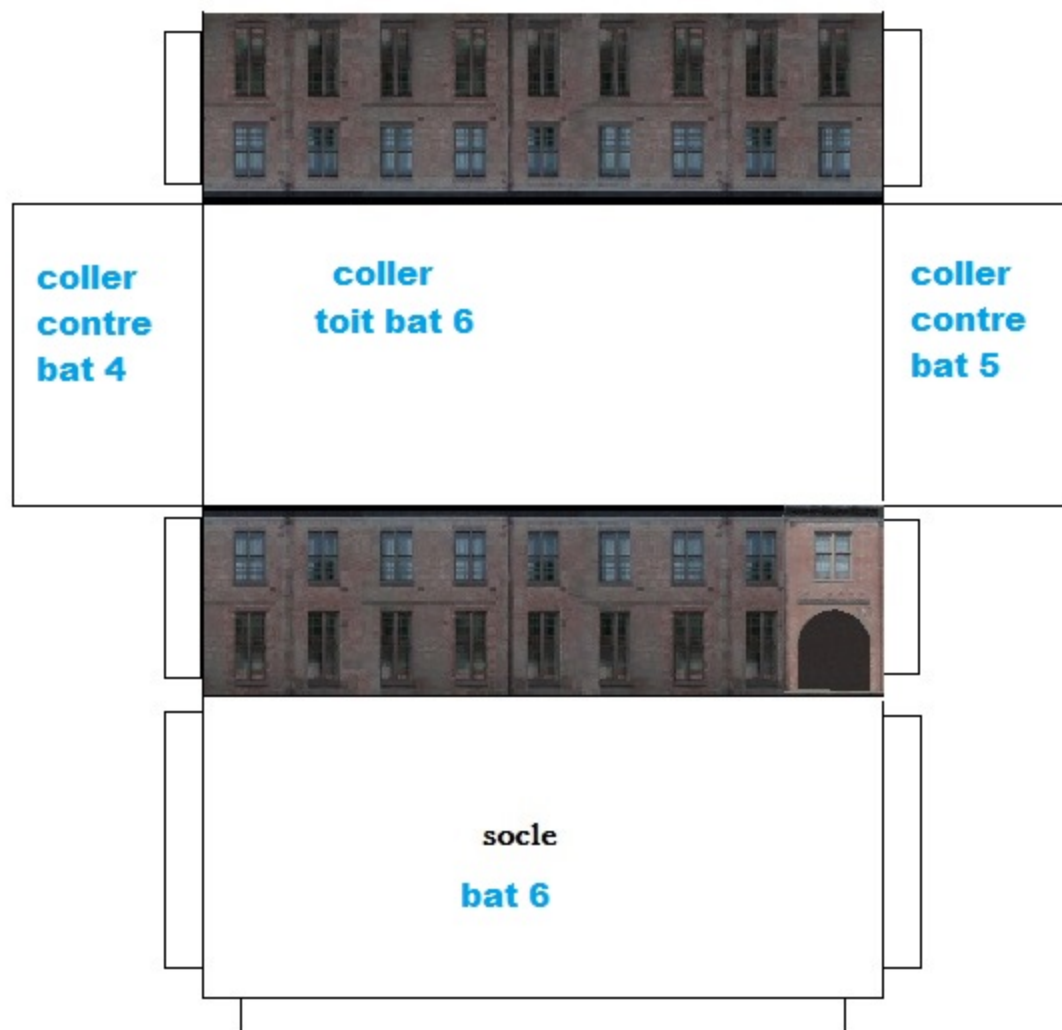
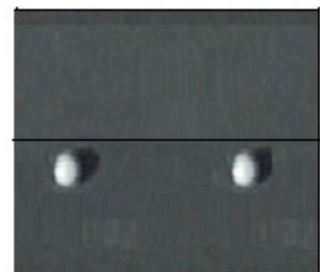
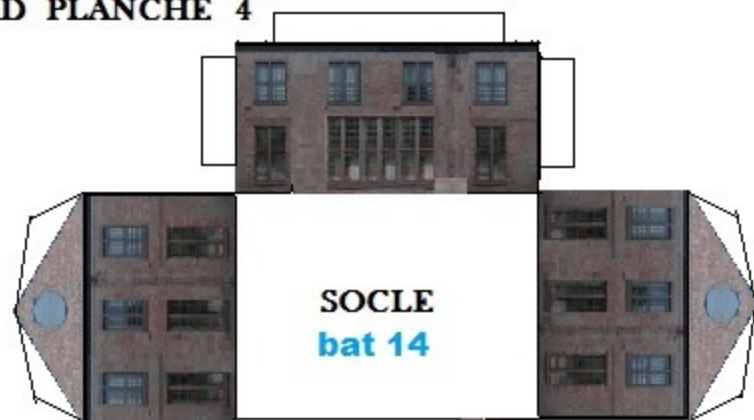

**toit bat 14**

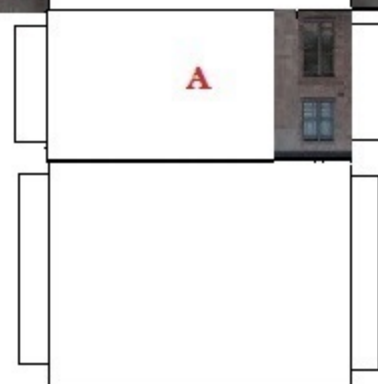

**coller façade  
A contre A**

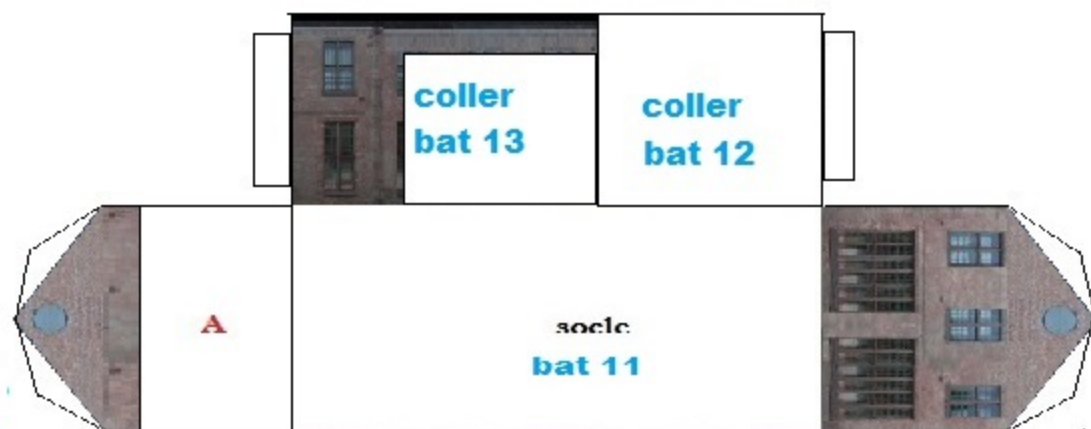

**coller  
bat 13**

**coller  
bat 12**

**socle  
bat 11**



**coller façade B  
contre B**



**coller  
contre bat 4**

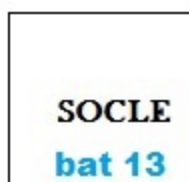

**coller  
contre  
bat 11**

**coller  
toit 13**



**toit bat 13**

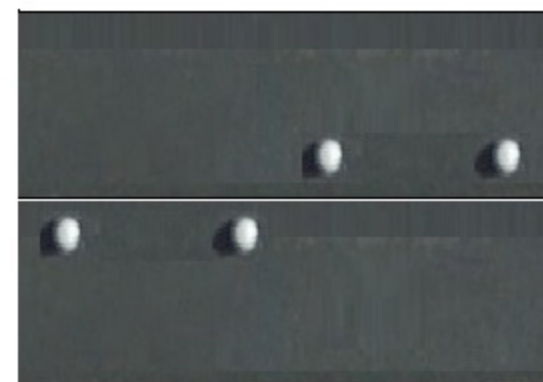

**toit bat 11**



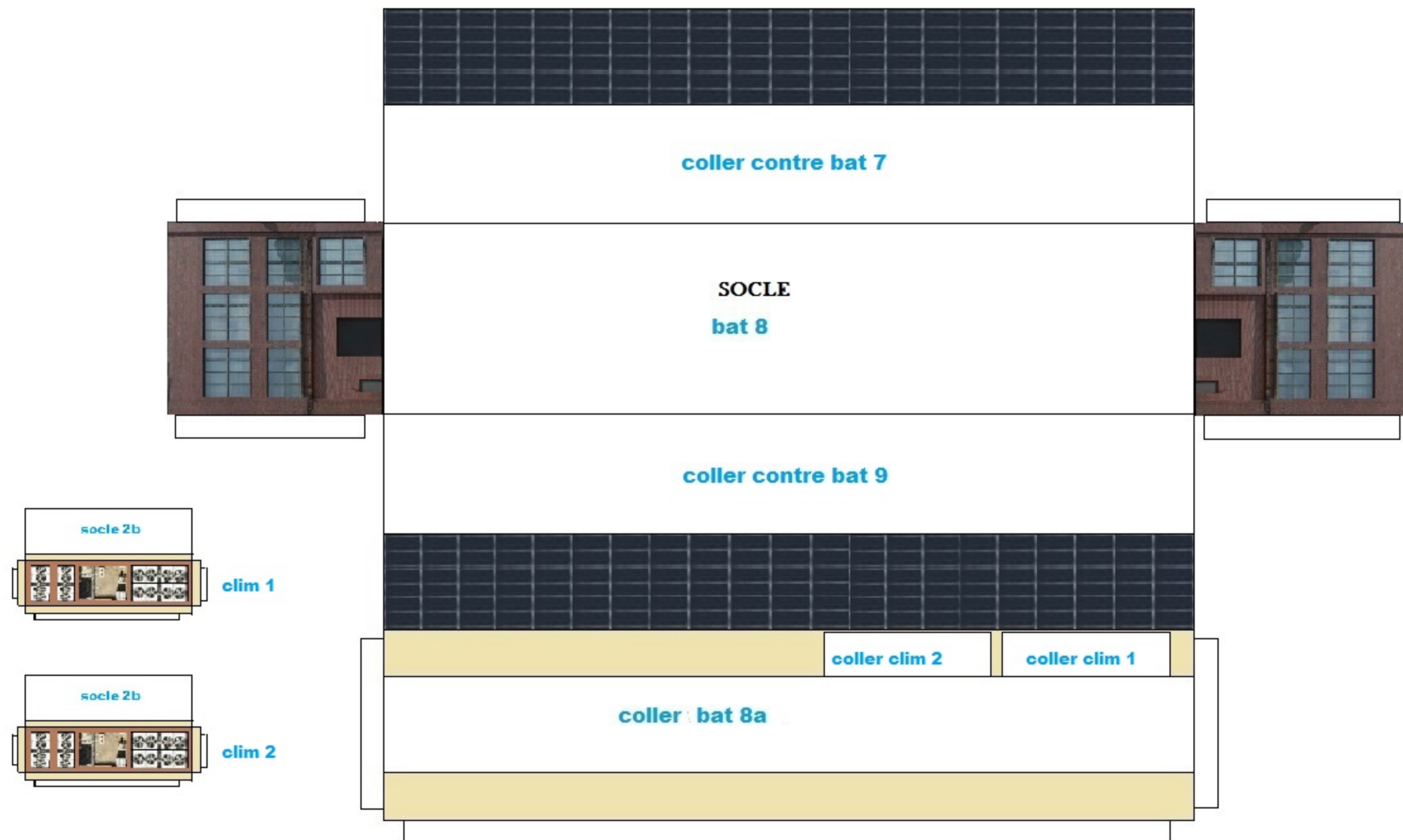



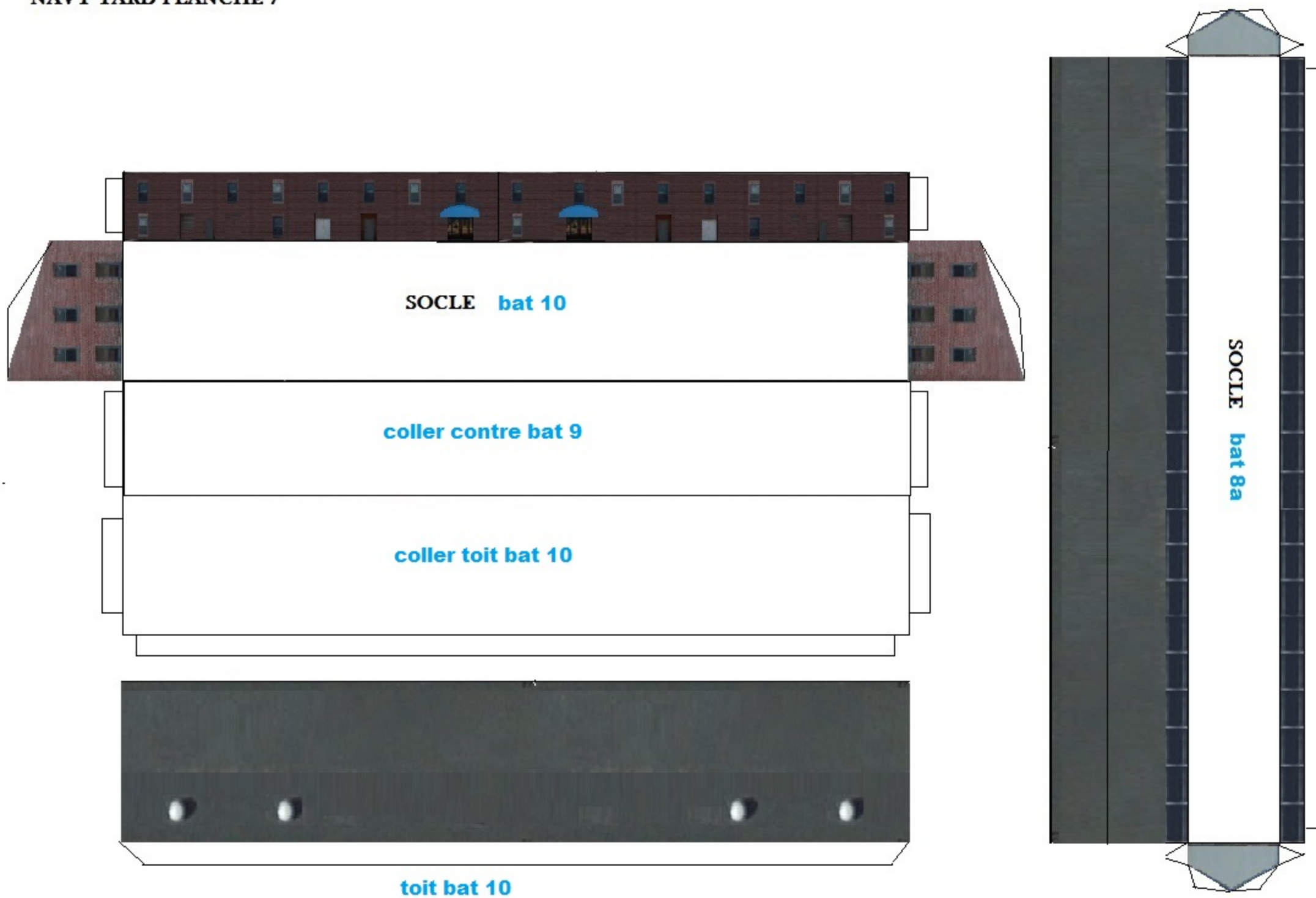

NAVY YARD

PLANCHE 8

socle toit bat 4

socle toit bat 5



NAVY YARD  
PLANCHE 9

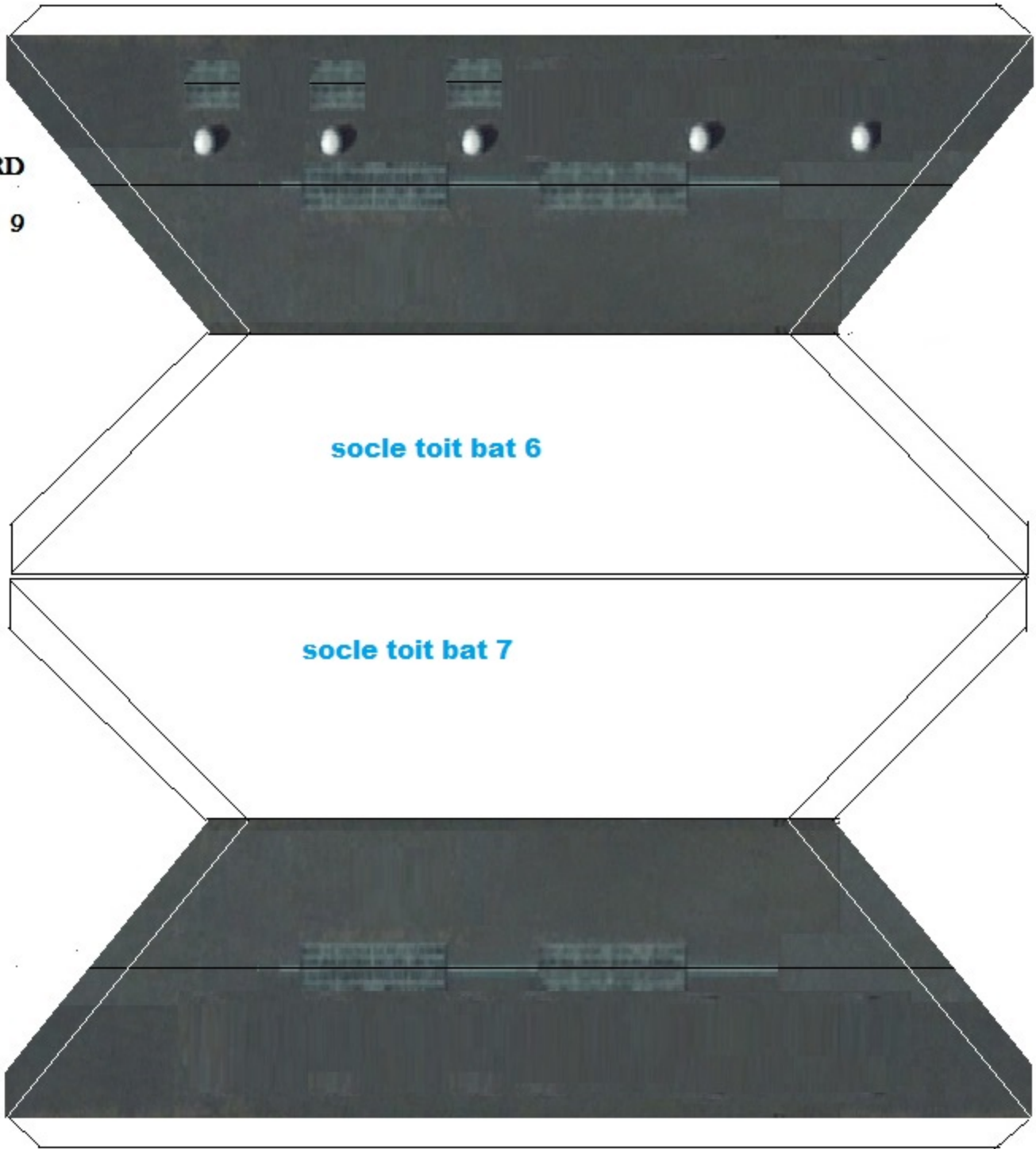

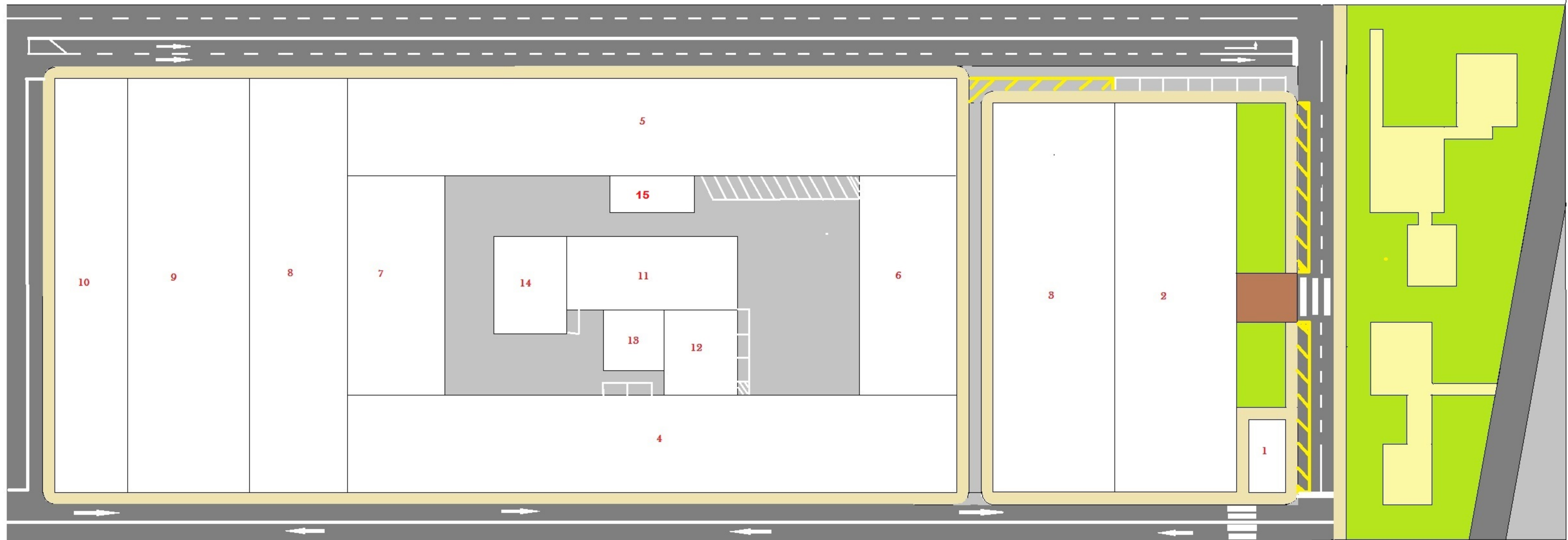

le socle prêt à recevoir les deux montages se trouve en 4 parties avec la maquette NCIS

